

INITIO RJ45 KEYSTONE JACK CAT6A, 10G



The INITIO category 6A 10G screened Jack is designed for a high speed data communications and meet all performance requirements.

It features a toolless termination method including a wire guide for quick and easy installation.

The **INIC6A10GS0HW** jacks are fully shielded to optimize protection from EMI, including Alien Crosstalk.

Its contact design provides enhanced plug-to-jack connection integrity, providing the highest level of reliability.

CHARACTERISTICS:

- Zinc-alloy fully shielded body
- Shielded RJ45 keystone type
- Rear cable entry
- Toolless
- Wiring standard EIA/TIA 568 A & B

SUPPORTED APPLICATIONS:

- IEEE802.3:
10GBase-T; 5GBase-T, 2.5GBase-T,
1000Base-T (Gigabit Ethernet),
100Base-Tx, 10Base-T
- ANSI / TIA / EIA: 1000Base-Tx
- IEEE 802.3af/at/bt (PoE/PoE+/4PPoE)

STANDARDS :

- ISO/IEC 11801
- EN 50173
- ANSI/TIA-568.2-D

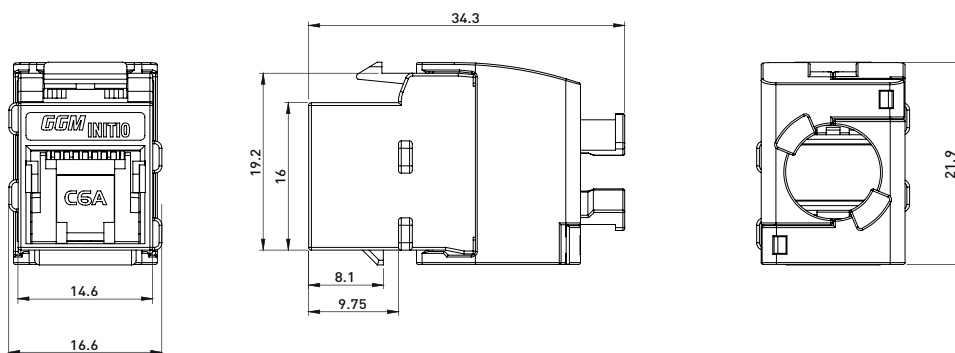

PART NUMBER

GGM INIC6A10GS0HW

GGM INIC6A10GS0HWB

DESCRIPTION

GIGAMEDIA INITIO TOOLLESS KEYSTONE JACK 10G CLASS EA, SHIELDED

PACK OF 50 GIGAMEDIA INITIO TOOLLESS KEYSTONE JACK 10G CLASS EA, SHIELDED