

## DIN RAIL FIBER BOX GGM DINFO6xxxx



This Fiber box is dedicated to industrial environment where no 19 inches format is available. Easy to install and with a compact design, the Gigamedia DINFO box allow the user to connect up to 12 fibers.

This box is a real added value that allows mixing fiber resources with electrical resources inside industrial cabinets.

### FEATURES

- Rear Entry by cable gland (PG 11) - top or bottom
- Integrated splice holders
- Accept shrink or crimp protection sleeves (depending on the version)
- Rear or aside Din rail fixation
- Up to 12 Fibers in SC, ST or LC duplex type
- RAL 7035 light grey, IP20
- Compact design saves space inside electrical cabinets
- Different density and connectors type combinations
- Can be delivered with SC, ST, LC, SC/APC loaded front plate
- In standard every version is loaded
- Temp range : -40 °C to +70 °C
- Dimensions : 35 (W) x 125 (H) x 133 mm (D)
- Weight: 0,65 kg

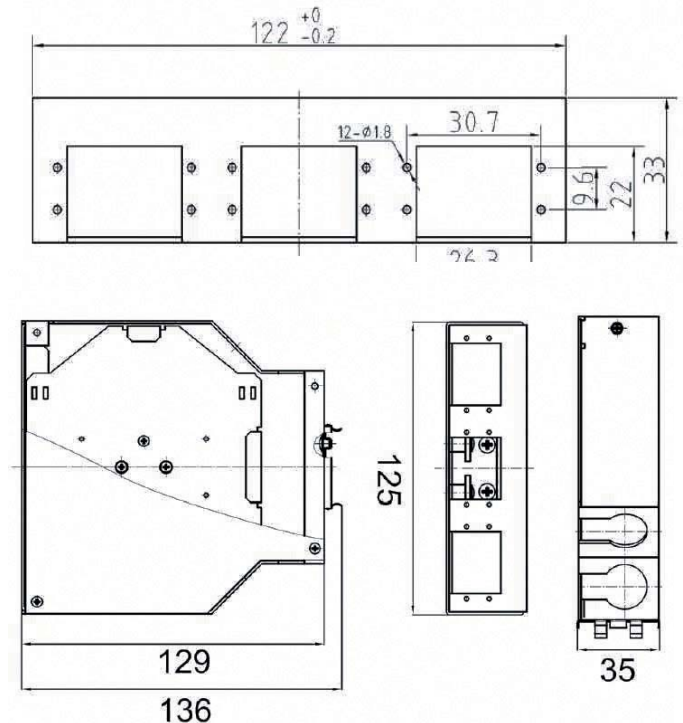

### PART NUMBER

PART NUMBER	DESCRIPTION
<b>GGM DINFO6SCMM</b>	DIN RAIL fiber box loaded with 6 SC duplex MM adaptors
<b>GGM DINFO6SCSM</b>	DIN RAIL fiber box loaded with 6 SC duplex SM adaptors
<b>GGM DINFO6STMM</b>	DIN RAIL fiber box loaded with 6 SC to ST duplex MM adaptors
<b>GGM DINFO6STSM</b>	DIN RAIL fiber box loaded with 6 SC to ST duplex SM adaptors
<b>GGM DINFO6LCMM</b>	DIN RAIL fiber box loaded with 6 LC duplex MM adaptors
<b>GGM DINFO6LCSM</b>	DIN RAIL fiber box loaded with 6 LC duplex SM adaptors